

2022 Impact Report

\$2,482,738

Total giving in communities across Kansas, Oklahoma and Texas in 2022.

Foundation Grants

\$2,083,300

19 New Grants

\$1,754,300

Community Enrichment & Assistance

\$240,000

Education & Workforce Development

\$89,000

Community Collaboration

Public School Funding

\$150,000

229 Grants

205 Teachers

176 Schools

United Way

\$1,678,654

1,770 Individual Donations

Matching Grants

\$186,650

279 Matching Grants



2022 Foundation Impact Report

FEATURED GRANTS

Kansas

Cooking with Gas at the NICHE

Philanthropic Focus Area: Education & Workforce Development

In Kansas, we partnered with **Wichita State University Technology** (WSU Tech) for their National Institute for Culinary and Hospitality Education (NICHE) in downtown Wichita. It will feature state-of-the-art commercial kitchens, classrooms, a demonstration kitchen, an open-to-the-public food hall, student-ran café and rooftop event center. The ONE Gas Foundation provided a grant to purchase specialized equipment.



WSU Tech students practice their culinary skills on the commercial natural gas stove.

Oklahoma

Making Play More Accessible

Philanthropic Focus Area: Community Collaboration



A rendering of The Center's new accessible playground.

In Oklahoma, we partnered with **The Center for Individuals with Physical Challenges** to support the construction of their new accessible playground. This will be the first fully accessible playground in Tulsa designed for youth with physical challenges. The ONE Gas Foundation provided a grant to support this project, which directly aligns with our Core Value of Inclusion & Diversity and our Employee Resource Group CAPABLE, which supports people with disabilities and their caregivers.

Texas

Fab Lab Zone at La Nube

Philanthropic Focus Area: Education & Workforce Development

In Texas, we partnered with **Fab Lab El Paso** to add a "Fab Lab Zone" in the new El Paso children's museum and science center, named La Nube (*the cloud in Spanish*), which opens in 2023. The ONE Gas Foundation provided a grant in 2022 to provide immersive, hands-on equipment for the Fab Lab Zone. All exhibits in the new museum will provide interactive STEAM (Science, Technology, Engineering, Arts and Math) education opportunities for youth.

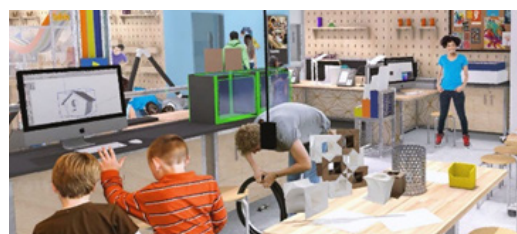

A rendering of the future Fab Lab Zone at La Nube.

2022 Foundation Impact Report

VOLUNTEER EFFORTS

Last year, employees across our footprint volunteered more than **5,800 hours** at local nonprofit organizations. In a year that saw us return to normal operations and return to our offices, we were especially excited to return to our roots of giving back and volunteering in person.

Even with busy lives, ONE Gas employees generously gave their time to make a positive impact in their communities. Some of the highlights of our volunteer projects include building houses, fighting food insecurity, supporting youth development and working toward community improvement.



Volunteers planted a mini orchard in a vacant lot in northeast **Wichita, Kansas**.



More than 25 employees volunteered at a "Touch-a-Truck" event in **Topeka, Kansas**.



Employees volunteered at the United Way Day of Caring in **Tulsa, Oklahoma**.



Retirees volunteered as Salvation Army bell ringers in **Tulsa**.



Employees in **Oklahoma City** volunteered at the local Litter Blitz.



Volunteers helped "Sound the Alarm" for the Red Cross in **El Paso, Texas**.



Employees and family members helped clean up a beach in **Harlingen, Texas**.

Giving to Date

	2022	2014-2021	TOTAL GIVING (2014-2022)
Total Foundation Giving	\$2,482,738	\$16,383,568	\$18,866,306
Foundation Grants	\$2,083,300	\$6,982,884	\$9,066,184
Public School Funding	\$150,000	\$1,053,429	\$1,203,429
# of Schools	176	574	750
United Way Total Dollars Given	\$1,678,654	\$7,846,781	\$9,525,435
Value of Matching Grants	\$186,650	\$1,260,757	\$1,447,407
Matching Grants	279	1,990	2,269
Share the Warmth Matching Grants	\$94,070	\$504,343	\$598,413
Volunteer Time Value	\$173,950	\$1.2 million+	\$1.4 million+
Employee Volunteer Hours	5,808	41,873	47,681

The volunteer time value is based on the national volunteer-hour value of \$29.95.